

Browse more than 1,300 woodworking project plans, DVDs, back-issue collections, videos, tool reviews, books, & more.

Thank You!

Thank you for ordering this *WOOD*® magazine download. We hope you enjoy being part of our online experience and that you have fun expanding your woodworking skills.

Please remember that this copyrighted material is for your use only. It is unlawful to share this file with someone else or to reprint it in any form.



Dave Campbell
Editorial Content Chief, *WOOD* magazine



Adobe Acrobat Reader Troubleshooting Guide

If you can read this page, your Acrobat Reader program is working correctly! But you may still have problems or specific issues, such as printing and saving your downloadable file.

My printer won't print the text correctly

Almost all printing problems are due to not enough free system resources memory. The files are very memory intensive because they include graphics, text, and photos. Close all other programs/applications and print directly out of the Acrobat Reader program, not your Web browser.

Patterns are not printing full-size

Make sure your printer is set to print at 100 percent, "print to fit" is not checked and "page scaling" is set to "none". These settings are selected in the printer setup or printer options.

I can't find my file now that it's downloaded

Rather than viewing the plan in your browser, you must save it to your hard drive. Download the file again, except this time try right-clicking on the red download button. A menu window will open. Select "Save target as" or "Save link as" to save the file to your hard drive. Once saved, you can open it up with Adobe Acrobat Reader.

For more details on using Adobe Acrobat Reader please visit our online help section at:

woodmagazine.com/adobe

WOOD Store

Customer Favorites

Shop Tools & Accessories



Indoor Furniture



Outdoor Furniture



Mission Furniture



Visit the WOOD Store at:

WOODStore.net



Triple-threat storage for lumber, scraps, and sheet goods



Build one or all three of these easy-to-make projects to keep your shop organized.

Storage Solution 1: Adjustable board bunks



Make as many of these adjustable racks as you need to store boards flat and out of the way. Wall-mount them over studs.

1 To make each rack, start by cutting two pieces of $\frac{1}{2}$ " plywood to the sizes shown on Drawing 1 to create the side plates for the board bunk.

2 From an 8'-long 2x4 cut a piece 40" long. Rip about $\frac{1}{2}$ " from one edge. Then rip the other edge to achieve the final $2\frac{1}{2}$ " width.

3 From the ripped stock, cut the dividers to length, as shown, making sure to miter both ends at 5° . (Note that the bottom divider is $4\frac{1}{8}$ "

long.) The workpiece is longer than you'll need, but this allows you to work around knots to make the dividers as strong as possible.

4 Cut a spacer $2\frac{13}{16}$ "-wide from a scrap of 2x4 stock, and use this as a spacer to align the dividers. Now glue and screw the dividers to the plates, where shown.

5 To make the arms, rip a second piece of 2x4 to $2\frac{3}{4}$ " wide. Again, avoid sections with knots to ensure maximum strength. (We made four arms for each rack assembly.) Miter one end of each arm at 5° . Then rout $\frac{1}{4}$ " round-overs on the edges and ends where shown. Don't rout the

mitered end. Sand all the parts through 150-grit, and apply a clear finish if desired.

6 To mount the rack assembly, locate your wall studs, and then drill $\frac{3}{8}$ " holes through four of the dividers, as shown. Use these holes to mark your wall, and then drill $\frac{1}{4}$ " pilot holes 2" deep into the studs. (If the studs are exposed—no drywall—then make the pilot holes $2\frac{1}{2}$ "-deep.)

7 Screw the rack assembly onto the studs using $\frac{3}{8}$ x5" lag screws, spacing them every 16" or 24". Slip in the arms, and add your prized lumber stock.

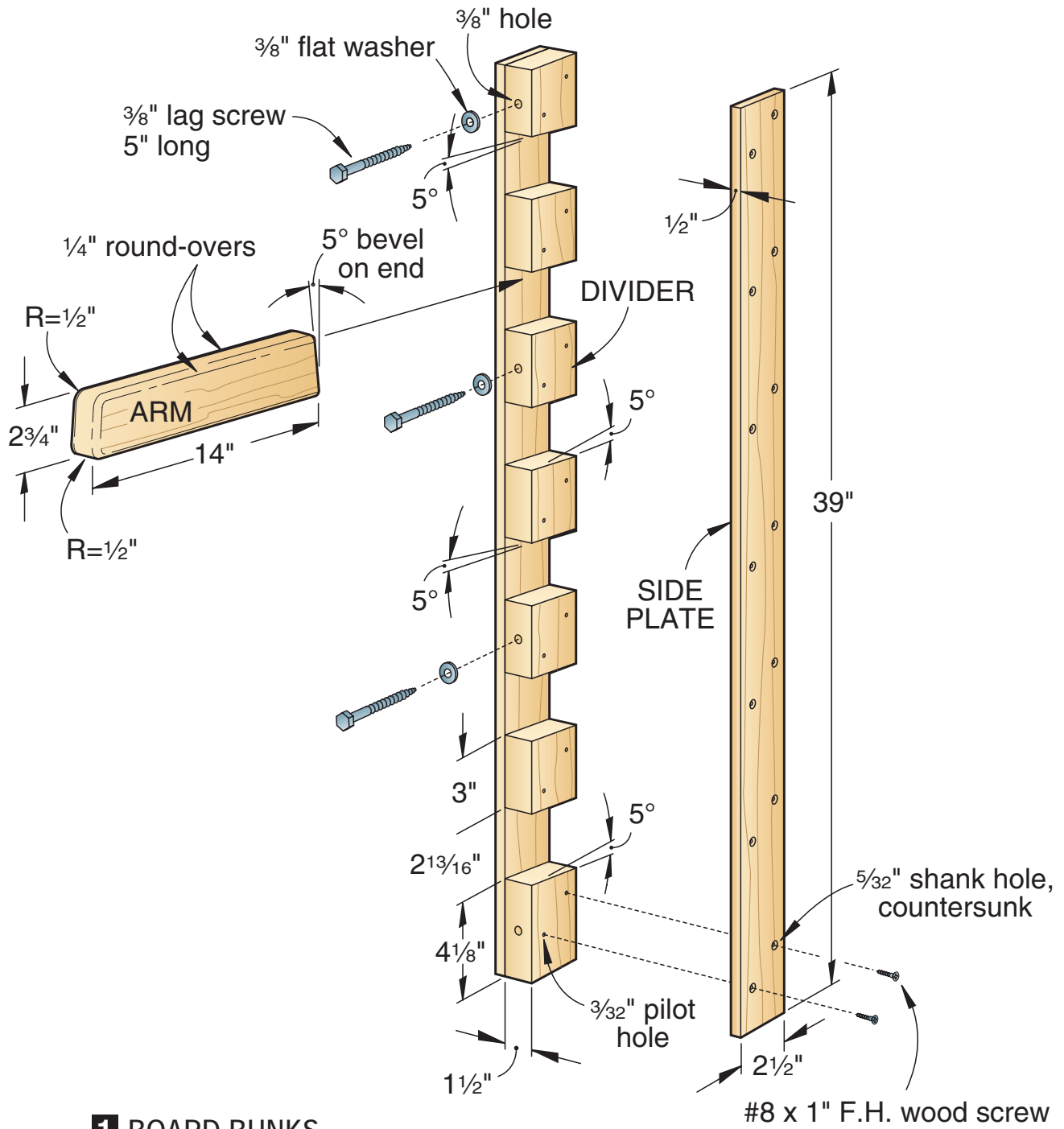

1 BOARD BUNKS

Storage Solution 2: Shop-smart scrap sorter



Corral your cutoffs with this handy mobile cart. It lets you organize your stock by length so you'll always know exactly what you have at a glance.

1 Begin by cutting the plywood sides, shelves, and dividers to the sizes shown on Drawing 2.

2 Rip stock (we used poplar) to size to create the edge banding. Then apply the edge banding, where

shown. This will dress up the project while protecting the plywood edges from nicks.

3 Place both side pieces face to face and drill shank holes for the #8x2" screws that will hold the cart together. Also drill shank and pilot holes, and then assemble each of the divider cubbies.

4 Sand the parts through 150-grit, and apply two coats of clear finish to all the cart's pieces.

5 Now assemble the cart. We used screws only—no glue—to allow tweaking the fit of each piece.

6 Install four 3" swivel casters to the bottom corners of the cart, where shown. To do this, turn the cabinet upside down, place a castor at each corner, mark and drill the holes, and screw the casters in place.

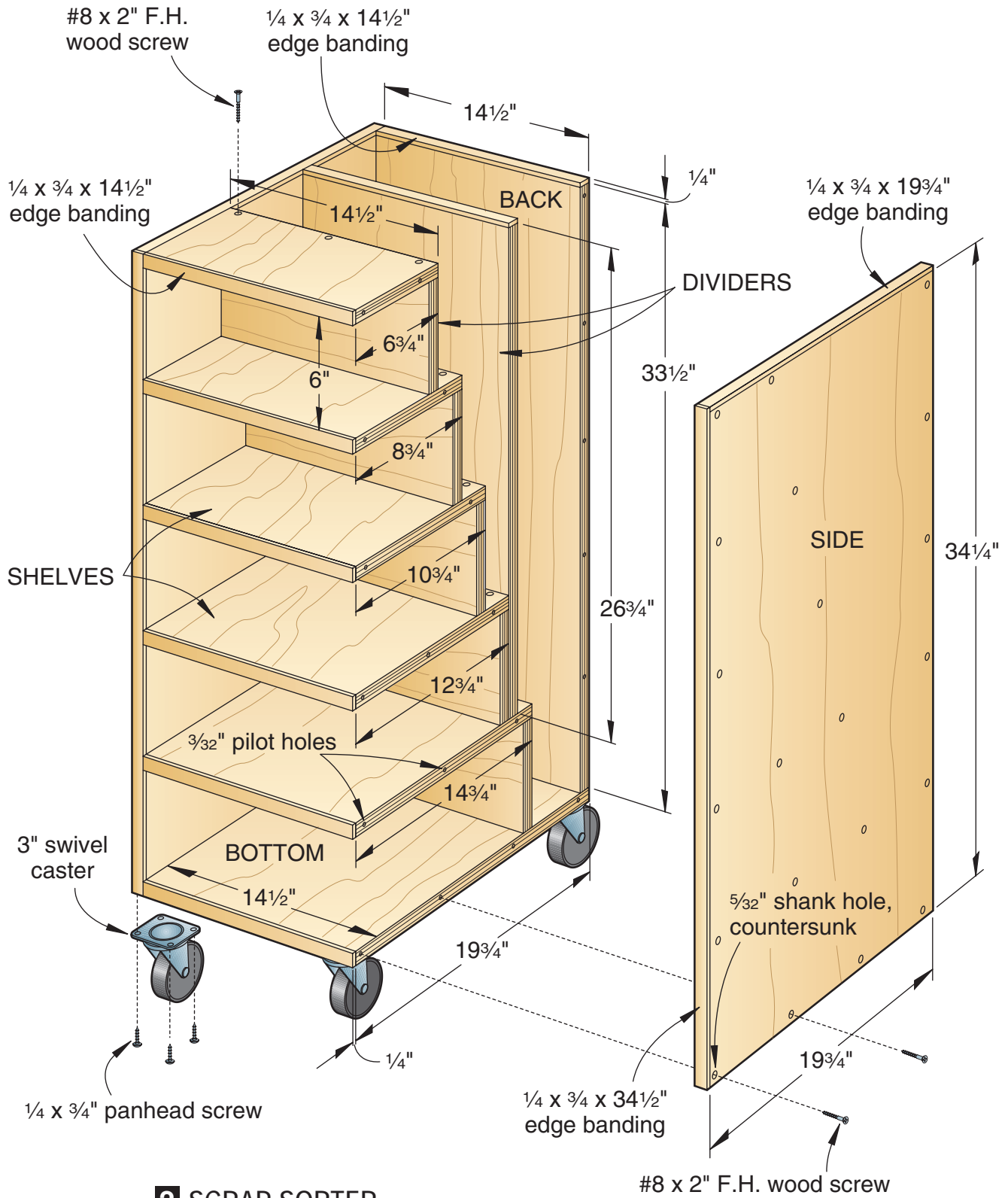

2 SCRAP SORTER

Storage Solution 3: Upstanding sheet storage cart



Sheet goods never store easily, and they take up a lot of shop space. This tall cart allows you to store full sheets, half sheets, and cutoffs in a small area. Though sizeable, it rolls around with little effort. We've even included wall-mounting brackets you can add if your shop floor is rough or out of level. If your ceiling is less than 9', take a pass on this project.

Note: For structural strength, we used 3/4" plywood; five sheets suffice for the project shown. If you intend to finish or paint the project, you'll find it easier to simply apply it to the full sheets before you begin cutting and assembly. We applied two coats of water-based finish using a paint pad, taking care to not coat the plywood edges.

1 Cut the top, bottom, back, and shelves to the sizes shown on Drawing 3.

2 Next, cut edge banding (we used poplar) to the sizes shown in the drawing. Note that the edge banding on the front edge of the top and bottom extends these plywood parts by 1", whereas the edge banding on the front edges of the top, bottom, sides, divider, and shelves extend the plywood parts by 1/4". This ensures alignment. Now, cut the shelf cleats to size.

3 Apply edging where shown, and the same finish or paint used on the plywood parts. Attach the shelf cleats using #8x3/4" screws.

4 Assemble the cart using #8x2" screws, as shown. You may want a friend to help move the configuration and steady the large pieces. We found it easiest to install the shelves between one side and the divider, and then add the back, top and bottom, and final side. When done, install 3" swivel casters, where shown. 🌳

Produced by Marlen Kemmet
Project design: Board Bunks: Jeff Mertz
Scrap Sorter, Sheet Good Storage Cart:
Jerry Lenz, Elizabeth, Colo.
Illustrations: Roxanne LeMoine
Graphic design: Lorna Johnson

WALL MOUNTING DETAIL

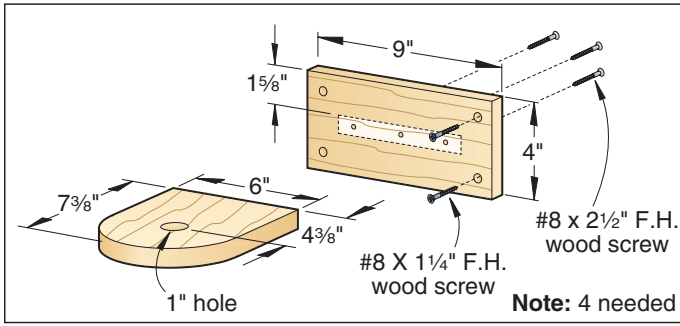

1 SHEET GOODS STORAGE CART

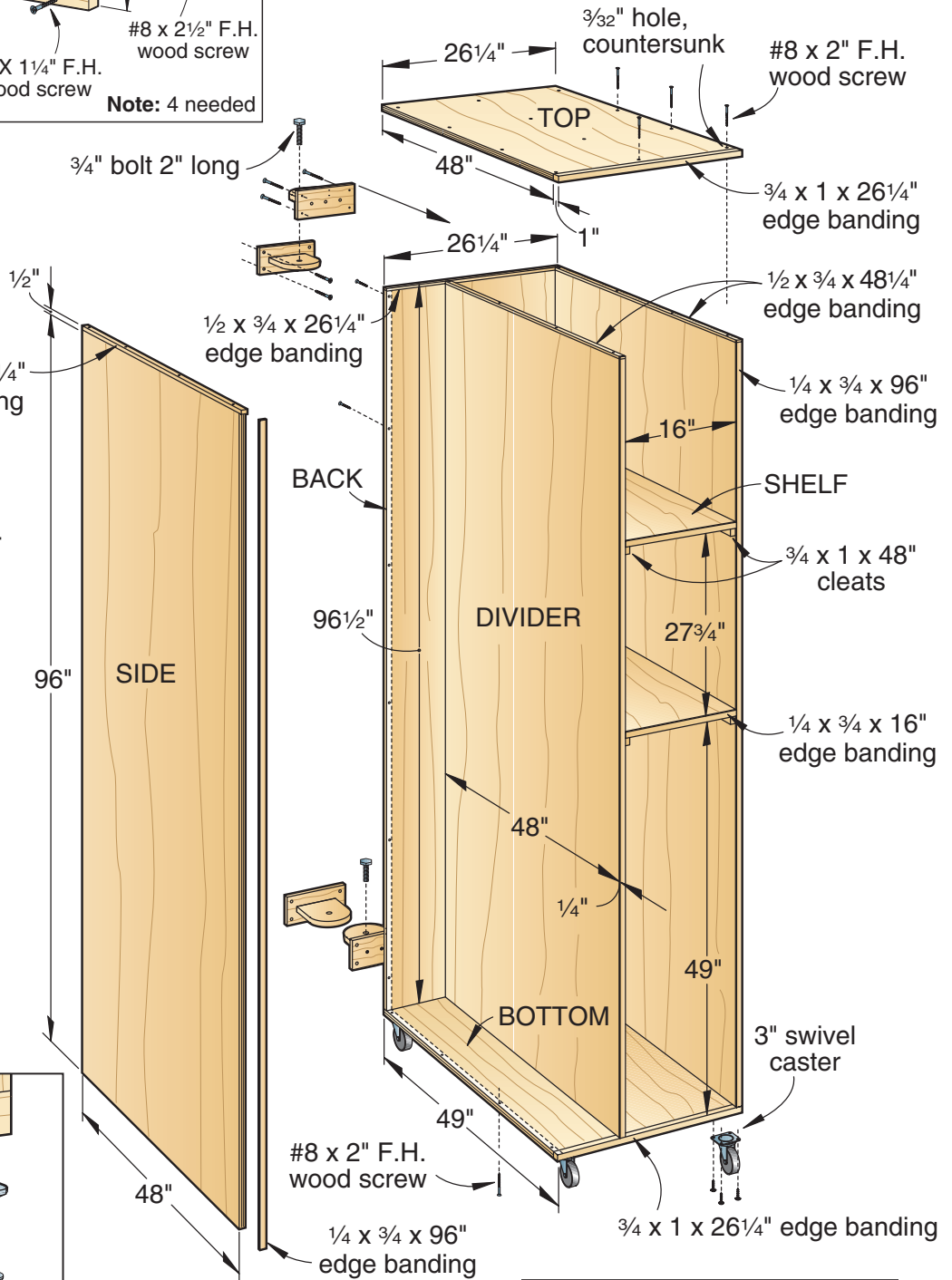

CASTER DETAIL

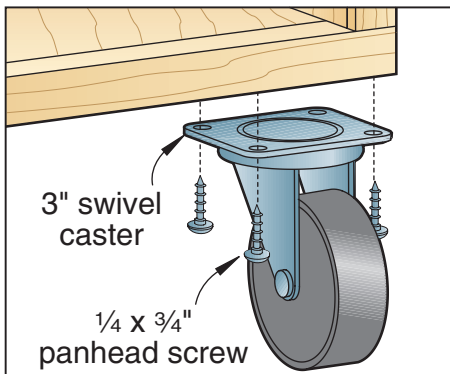

The purchase of these plans does not transfer any copyright or other ownership interest in the plans, the design or the finished project to the buyer. Buyer may neither reproduce the plans for sale nor offer for sale any copies of the finished project.

3 Ways to better your woodworking

from the editors of **WOOD** Magazine

1 All 26 Years of **WOOD** on one Disc!



The easy searchable index takes you instantly to

570 Tool Reviews	810 Skill-building Techniques	250 Shop Projects
1,625 Shop Tips	305 Furniture Projects	920 Weekend Projects

Order online at woodmagazine.com/DVDlibrary
or by phone at **888-636-4478**

2 New Woodworking Videos

50% OFF!

When you buy two or more videos

Buy one at regular price (\$19⁹⁵ each) or save by purchasing two or more for **\$9⁹⁵** each.



Limited time offer!
Order today at
woodmagazine.com/videodvds

3 1,300+ Shop-tested Woodworking Plans

woodmagazine.com/plans

